

Assembly Guide

GTX Oyster Basket

The GTX Oyster Basket features an improved structure and attachment functionality while allowing for middle-of-the-range stock holding capacity. Contained within this document are instructions for assembling the GTX Oyster Basket as recommended by SEAPA.



Assembly Instructions

General Recommendations

- SEAPA recommends, to help with the assembly of the basket that the temperature of the parts are 24C or 75F degrees.
- We have developed and designed our latest product with materials that are both strong and durable so you will need to apply firm pressure when forming the basket.

1 STEP

CHECKING THE GTX PARTS

Check you have all the parts needed to construct the GTX oyster basket.

ID	Part Name	No.
A	End Cap with Door	#3123
B	End Cap	#2123
C	Clip	#4610
D	Clip Lock	#6601
E	Locking Bar	#6600
F	GTX Mesh	#1023

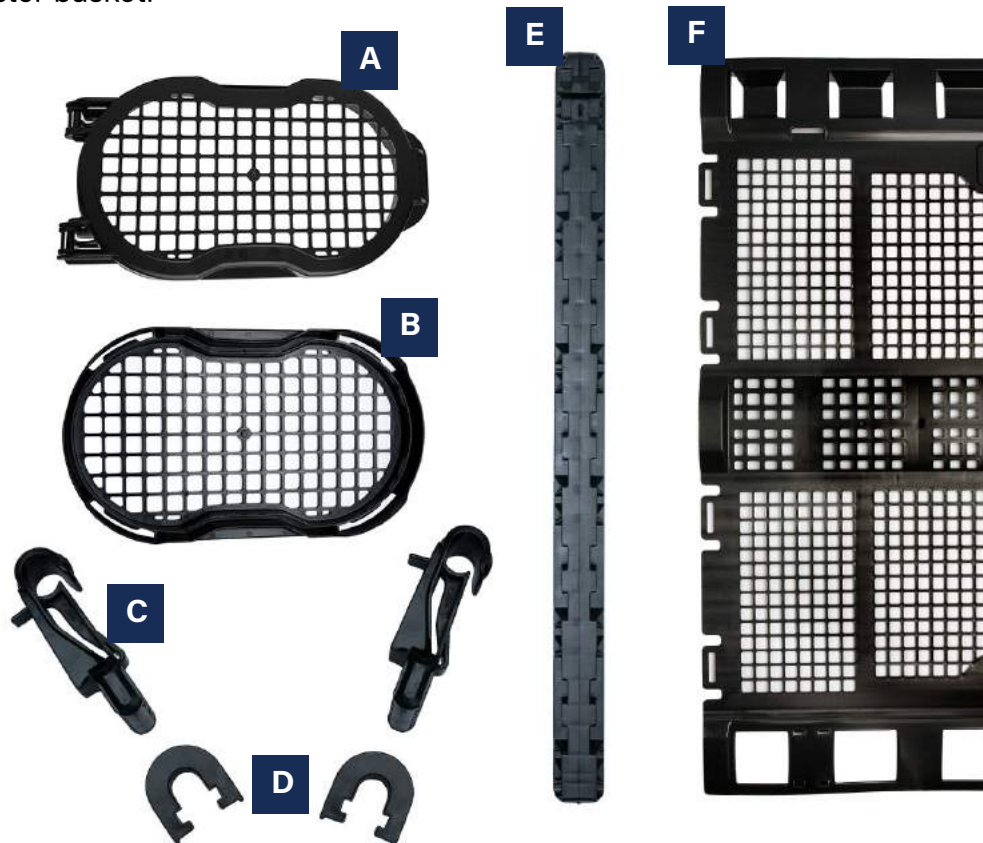

2

STEP

PREPARING TO FORM THE MESH CYLINDER

Take **Part F mesh #1023** and flatten it out on a level surface with the castellations facing down.

Note: We recommend using a flat and level surface e.g., a work bench for leverage

First you need to fold and roll the mesh, so the castellation housings go over the castellations to form an oval shape. Next you need to locate the tongue and fit it into the tongue insertion point.

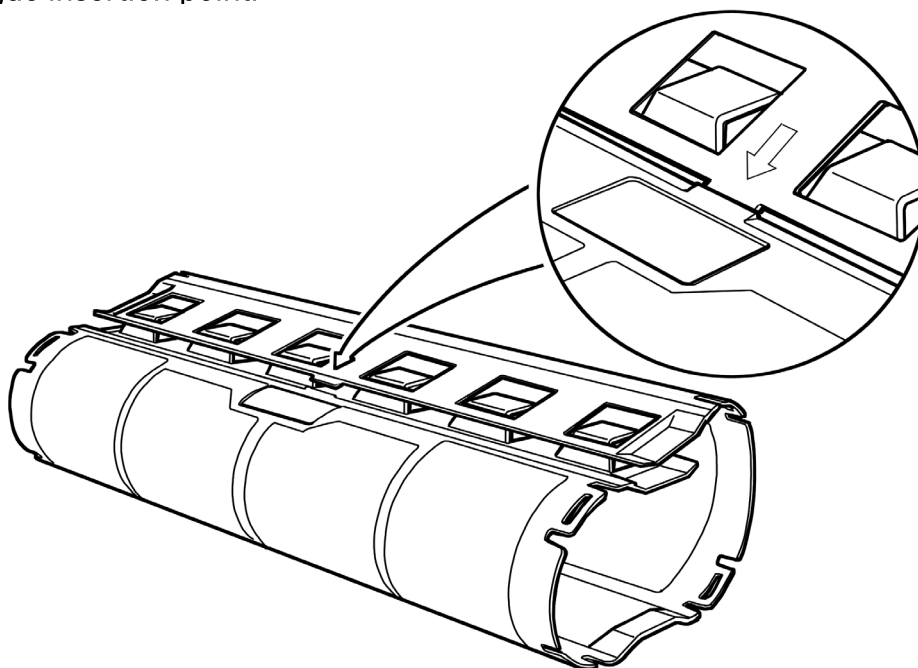

3

STEP

INSERTING THE LOCKING BAR TO THE BASKET

Now take **Part E locking bar #6600** and using the directional arrow marked on the locking bar you align it with the directional arrow marked on the mesh castellation.



You'll need to push/insert the locking bar through the first castellation marked with the directional arrow.

When you have pushed the locking bar through the last castellation you will hear a "clicking" noise which means the bar is locked in the central position.

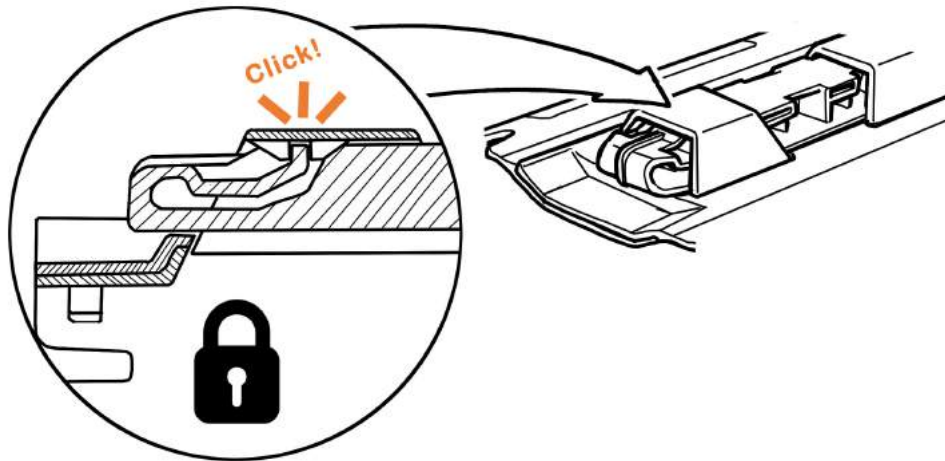

4 STEP

ATTACHING THE END CAP

Attach the **Part B end cap #2123** to the end you inserted the locking bar by firmly pushing together the end cap tabs to the ears on the end of the mesh cylinder.

Note: We recommend you have the basket in a vertical position on the floor and apply downward pressure on the end cap so you can see all sides of the oval to locate the locking tabs.

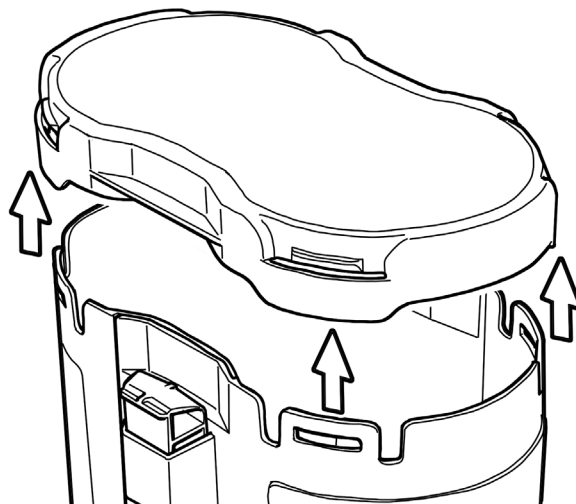

5 STEP

PREPARING TO ATTACH THE CLIP LOCKS

You must push the locking bar past the central position to the receive position to attach the clips. You must push down with your thumb on the nose of the locking bar and with the other hand push the locking bar tail in the same direction as the arrow. You will see the tail of the locking bar stick out from the last castellation.

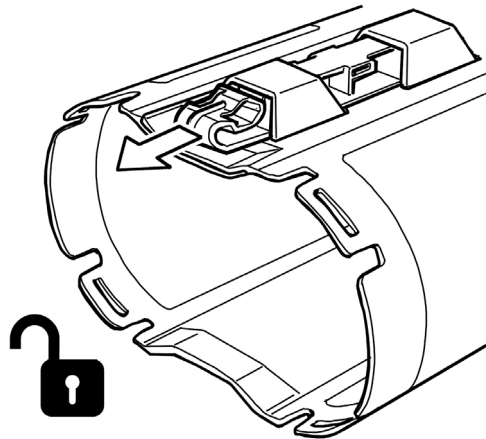

6 STEP

MAKING CLIP LOCKS AND ATTACHING

You need to get **Part C clip #4610** and attach **Part E clip lock #6601** lugs to the clip's axle so you can attach the clips to the mesh basket. You will need to attach two clips to the basket's locking bar between the castellations on the same side of the basket. You must attach the clip lock lugs to the locking bar before you re-engage it.

NOTE: We recommend you position the clips consistently on the oyster baskets in your farm.



7 STEP

RE-ENGAGING THE LOCKING BAR

You'll will need to re-engage the locking bar by pushing down with your thumb on the nose of the locking bar and with the other hand push the locking bar back to the central position.

If you find the clip and clip locks get stuck on the locking bar, when re-engaging it, you should apply download pressure on the clip and clip locks while continuing to push the locking bar.

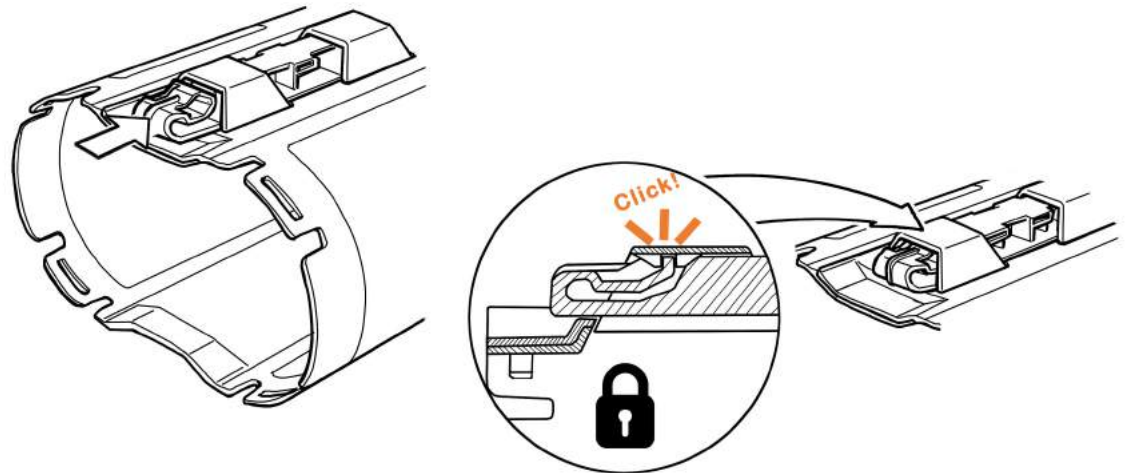

8 STEP

ATTACHING THE END CAP WITH DOOR

Now take **Part A end cap with door #3123** and use the same method as **Step 4** to attach it to the mesh basket. You need to make sure the end door hinges are on the left of the basket and the door latch is on the right.

NOTE: We recommend opening the door to see the locking tabs and ears when you push the parts together.

We recommend attaching the endcap door in a consistent configuration on each oyster basket used in your farm.



9
STEP

CHECKING YOUR BASKET IS SECURELY ASSEMBLED

Check you have assembled your basket securely and your locking bar is engaged by grabbing the clips and pulling on them to check if the locking bar will dislodge.



10
STEP

IDENTIFICATION BADGE (optional)

If you would like to use this option, please talk to your SEAPA representative about how to fit your badge.





SEAPA N. America

Erik Schlagenhauf - West Coast
Phone: (707) 242 1451
Matt Will - East and Gulf Coasts
Phone: (857) 598 2522
Email: team@seapausa.com

SEAPA Europe

Baptiste Foret
Tél: +33 07 72 37 37 33
Email: baptiste@seapa.fr

SEAPA Asia

Takehiro Yoshimoto
Phone: +81 50 3561 8240
Email: japan@seapa.com.au

SEAPA Australia

Head Office
Phone: +61 8 8357 6611
Email: sales@seapa.com.au